

Datasheet

Product type: **Duct Silencer**
 Product ID: 158220
 Product name: SD 00200 500 R 05

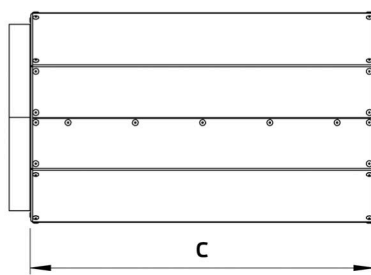
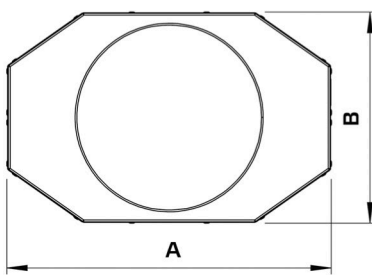

| | | | |
|--------|----|-----|---|
| A | mm | 432 | <ul style="list-style-type: none"> · Duct Silencer, rigid · Mineralwool insulation · Sheet steel, galvanized |
| B | mm | 280 | |
| C | mm | 460 | |
| Weight | kg | 7.1 | |

Use:

- EMI 200 E2M 50W O 01
- EMI 200 EC 120W O 01

Noise insertion loss dB

| | | | | | | | | |
|----|----|-----|-----|-----|------|------|------|------|
| Hz | 63 | 125 | 250 | 500 | 1000 | 2000 | 4000 | 8000 |
| | 0 | 5 | 12 | 17 | 19 | 21 | 14 | 13 |

Tested according to EN ISO 7235: 2010